

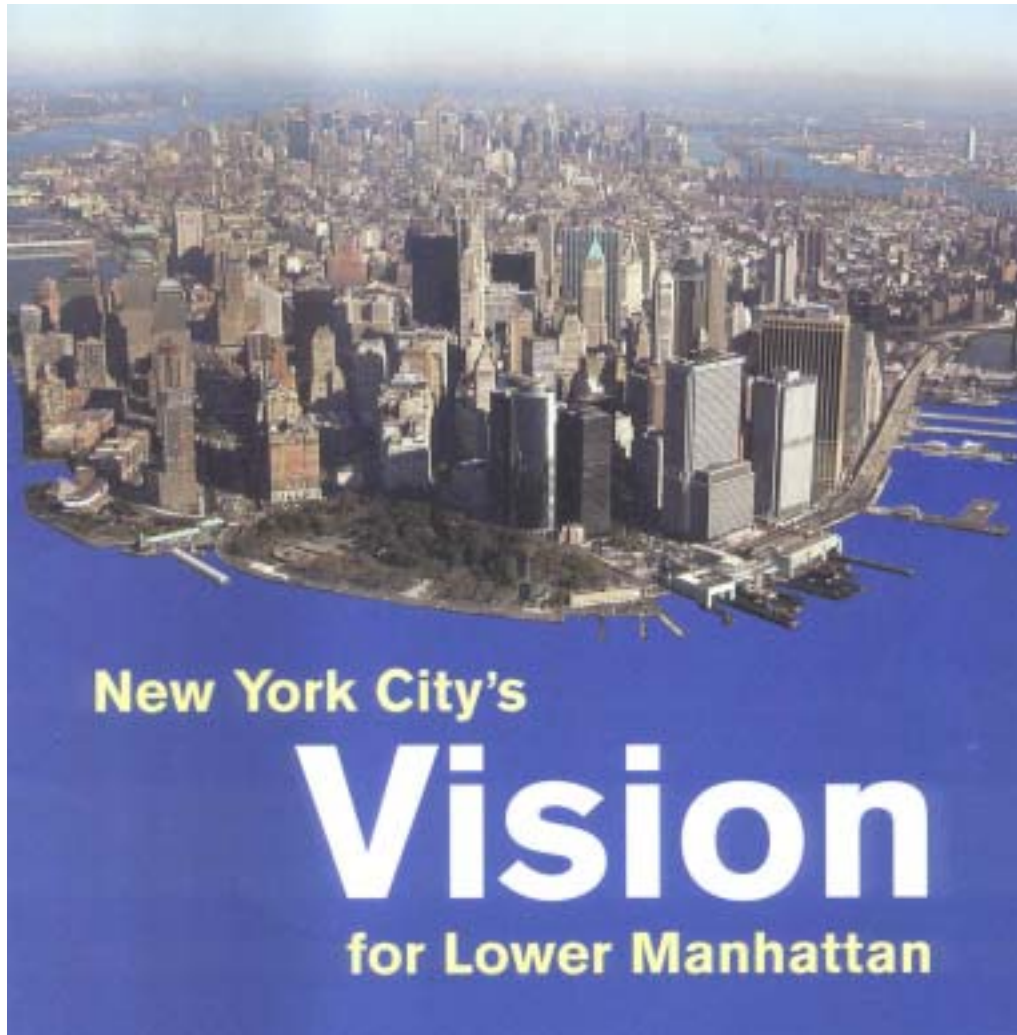

**East River  
Waterfront Study**

**Foundation Projects**

## Mayor's Vision, December 2002



# Lower Manhattan Initiatives

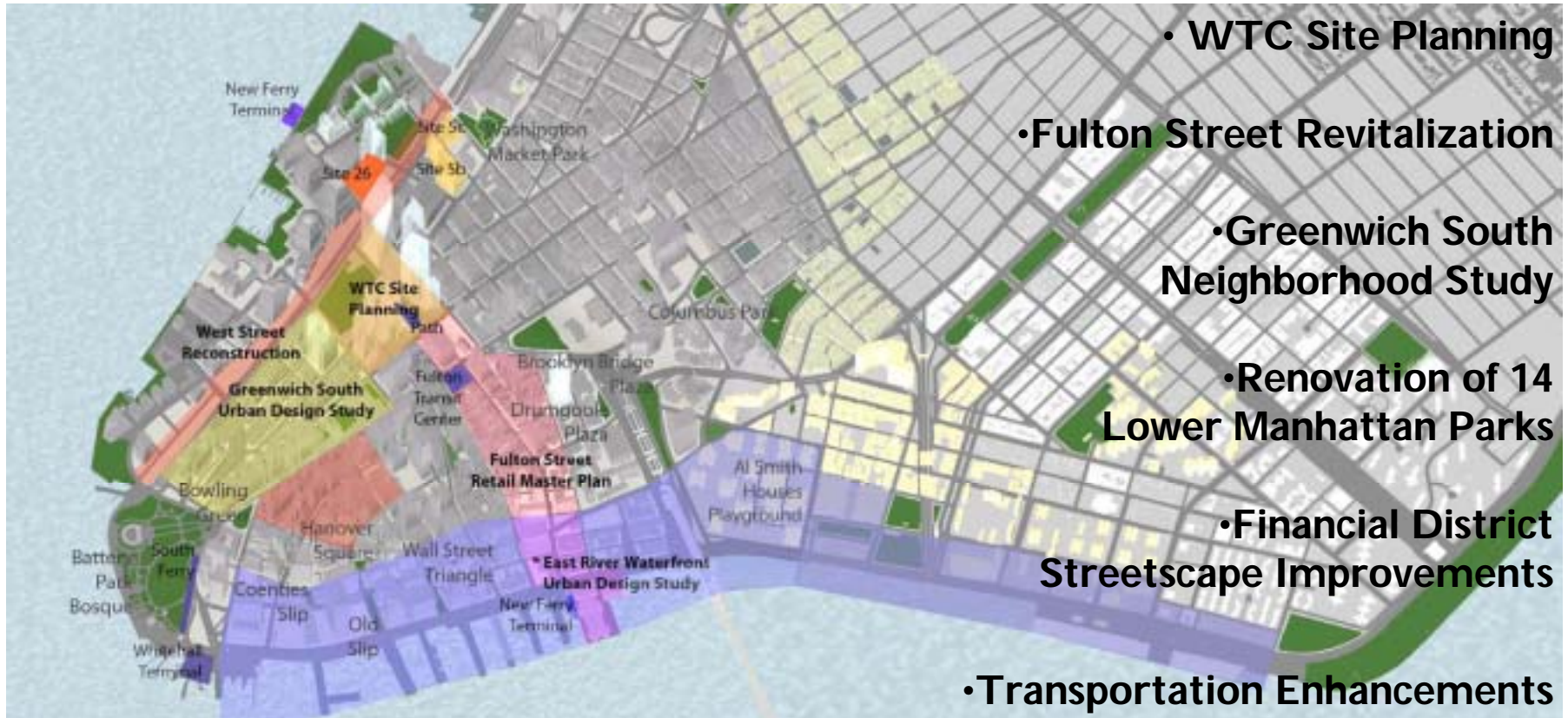

- WTC Site Planning
- Fulton Street Revitalization
- Greenwich South Neighborhood Study
- Renovation of 14 Lower Manhattan Parks
- Financial District Streetscape Improvements
- Transportation Enhancements

## East River Waterfront Study Goals



- Enhance access to waterfront
- Complete the Manhattan greenway
- Create a vibrant, world class water's edge
- Reconnect the city to its Waterfront

## Existing Conditions

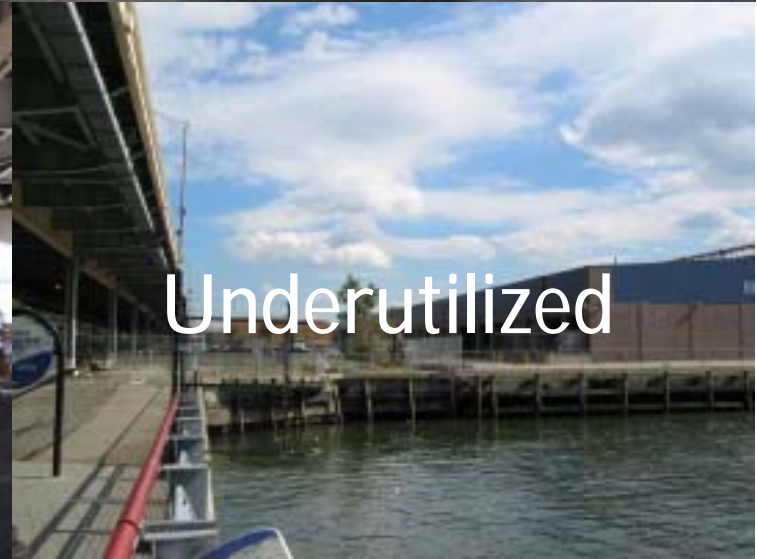

## Urban Design Challenge: Cross Grain Connection

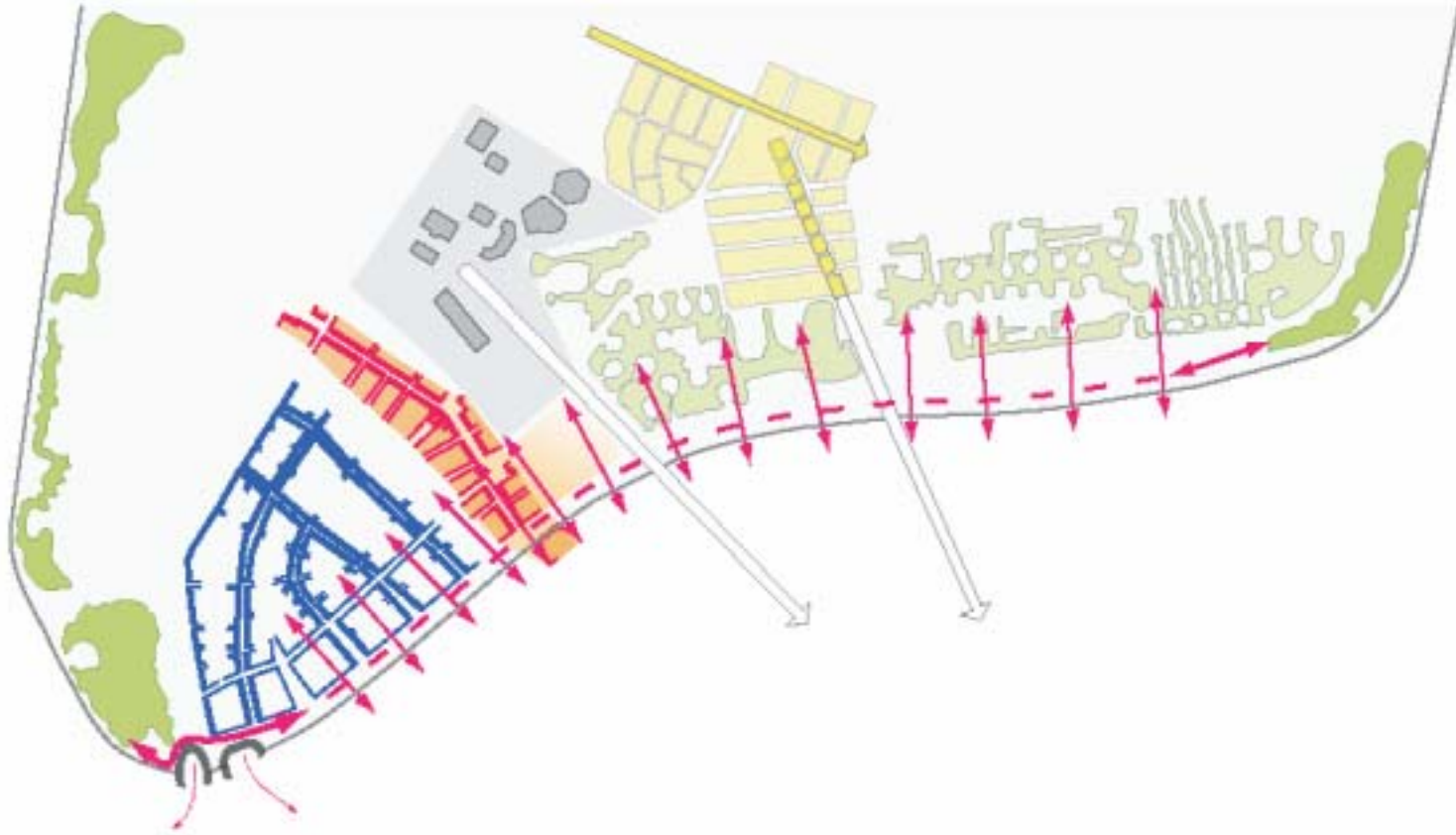

- Provide connections from each community to the East River
  - Reinforce the use of the water's edge
- Develop a clear and consistent waterfront strategy

## Urban Design Challenge: Access Points

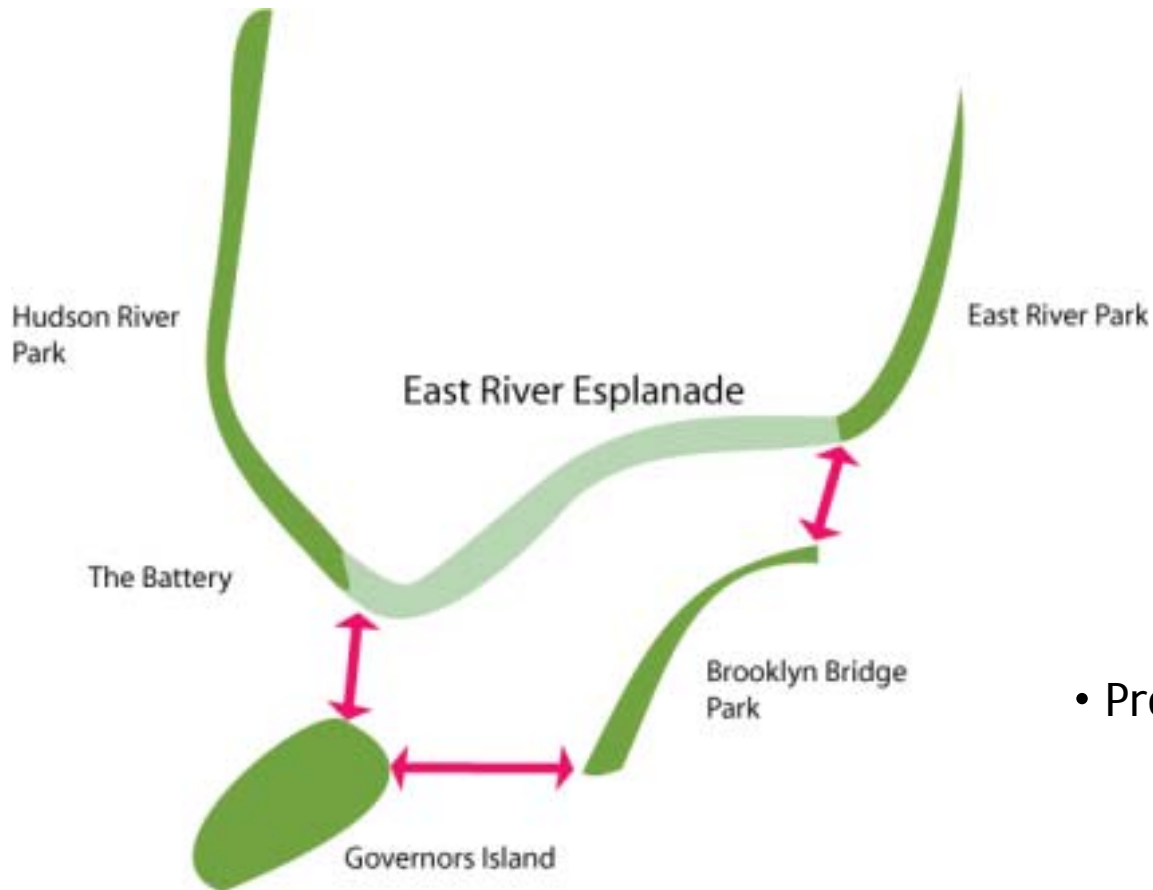

- Provide a green link to connect the Battery to East River Park
- Enhance the future gateway to Governors Island
- Link upper harbor parks together to form a network of open space around the river

## Urban Design Challenge: Waterfront Park Space

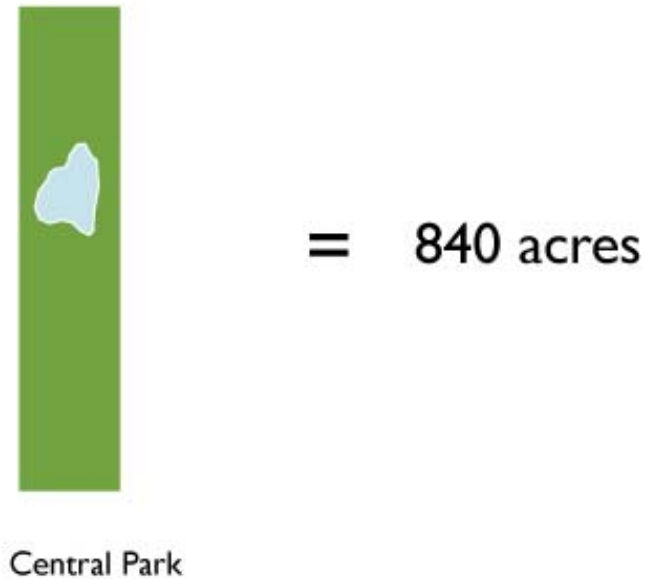
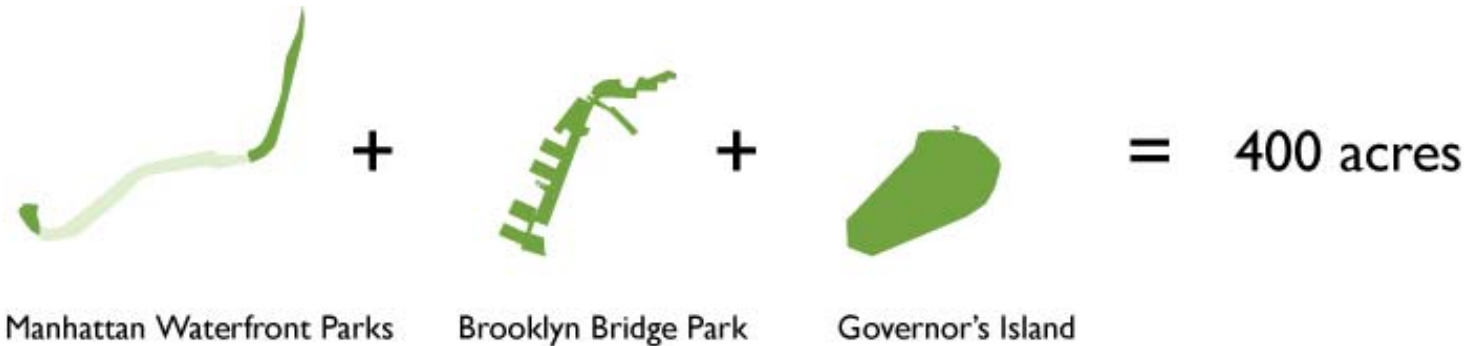

- Completing the green link between the Battery and East River Park will provide a waterfront amenity half the size of Central Park

# The East River Waterfront – Historical Context



# The East River Waterfront – Historical Context



# Existing Waterfront Types



Highway + Park



Natural Wetlands

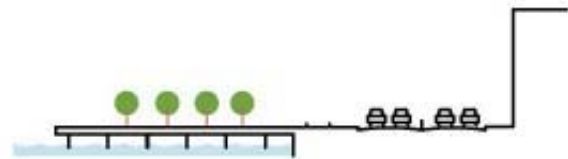

Boulevard + Piers



Beach + Boardwalk

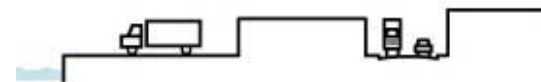

Industry + Infrastructure

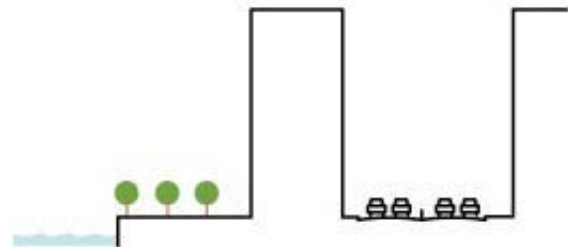

Planned Esplanade



Transportation + Infrastructure

# Existing Waterfront Types

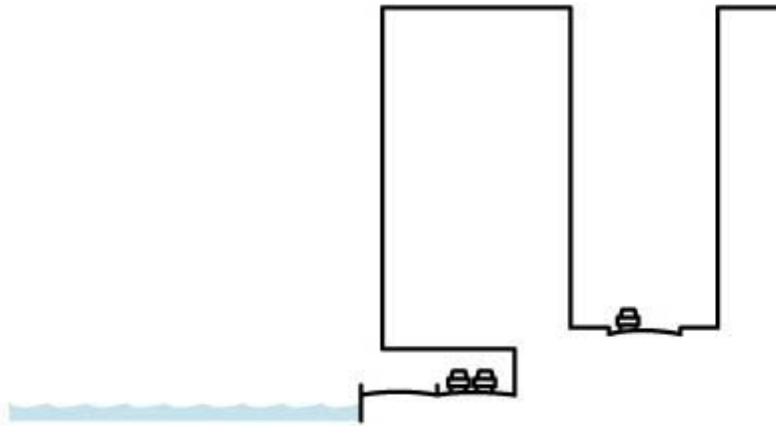

Buildings over Highway

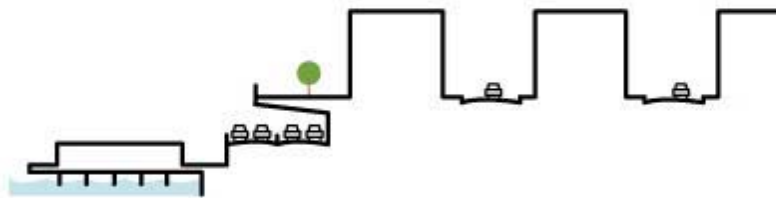

Esplanade over Highway

# Existing Waterfront Types

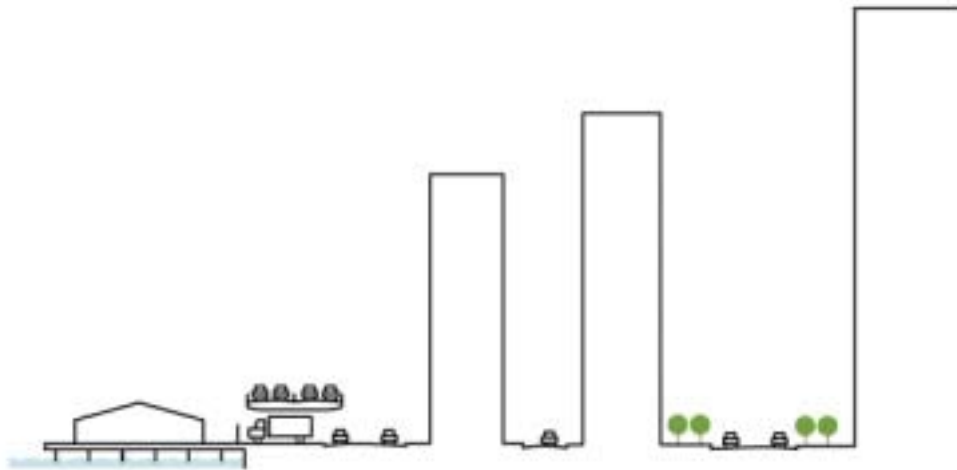

Current Lower East River

# New Waterfront Type

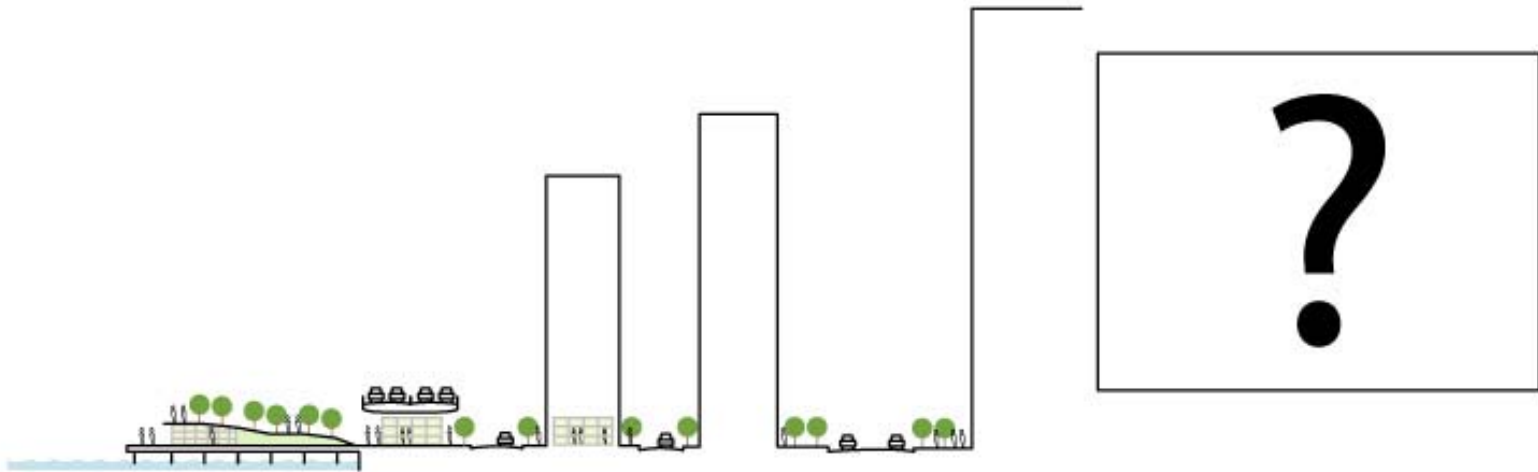

## Urban Design Solution: Foundation Projects



- Enhance access to and along the waterfront
- Identify short-term improvements that can be realized in the near future
  - Reconnect the city to the water's edge and the waterfront to the city
    - Build on existing community plans
  - Limit improvements to avoid regulatory delays

**New Esplanade**



**Battery Maritime Building**



**Pier 15**



**Burling Slip**



**New Market**



**Peck Slip**



**Catherine Slip**



**Pike / Allen**



**Pier 35**



**Pier 42**





## New Esplanade – Objectives

- Provide community green space on the water
- Learn from Hudson River Park
- Provide community green space for recreation



# New Esplanade Prototype



# New Esplanade Materials



Esplanade Planter



Seating



Railing with fishing pole holder, signage and view finder



Trellis with swing





## New Esplanade Pavilions Under the FDR





# New Esplanade Layout

Fulton – Catherine  
Esplanade Width = 24'-0"

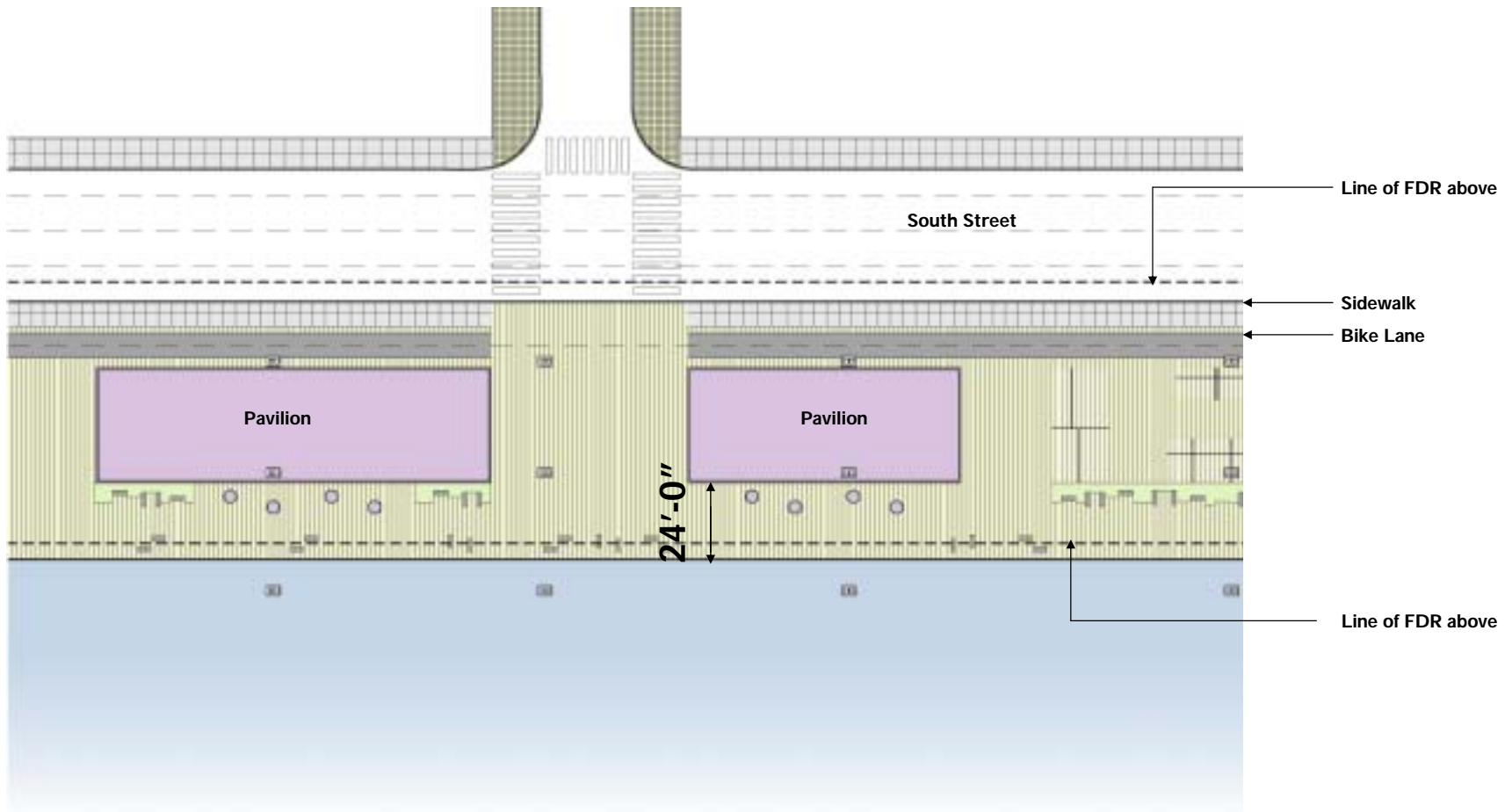



# New Esplanade



Bike Path

Potential Outdoor  
Farmer's Market

Plantings

Improved  
Boardwalk

Benches

Railing

Pavilions



# New Esplanade Layout

Wall Street – Fulton  
Esplanade Width = 58'-0"

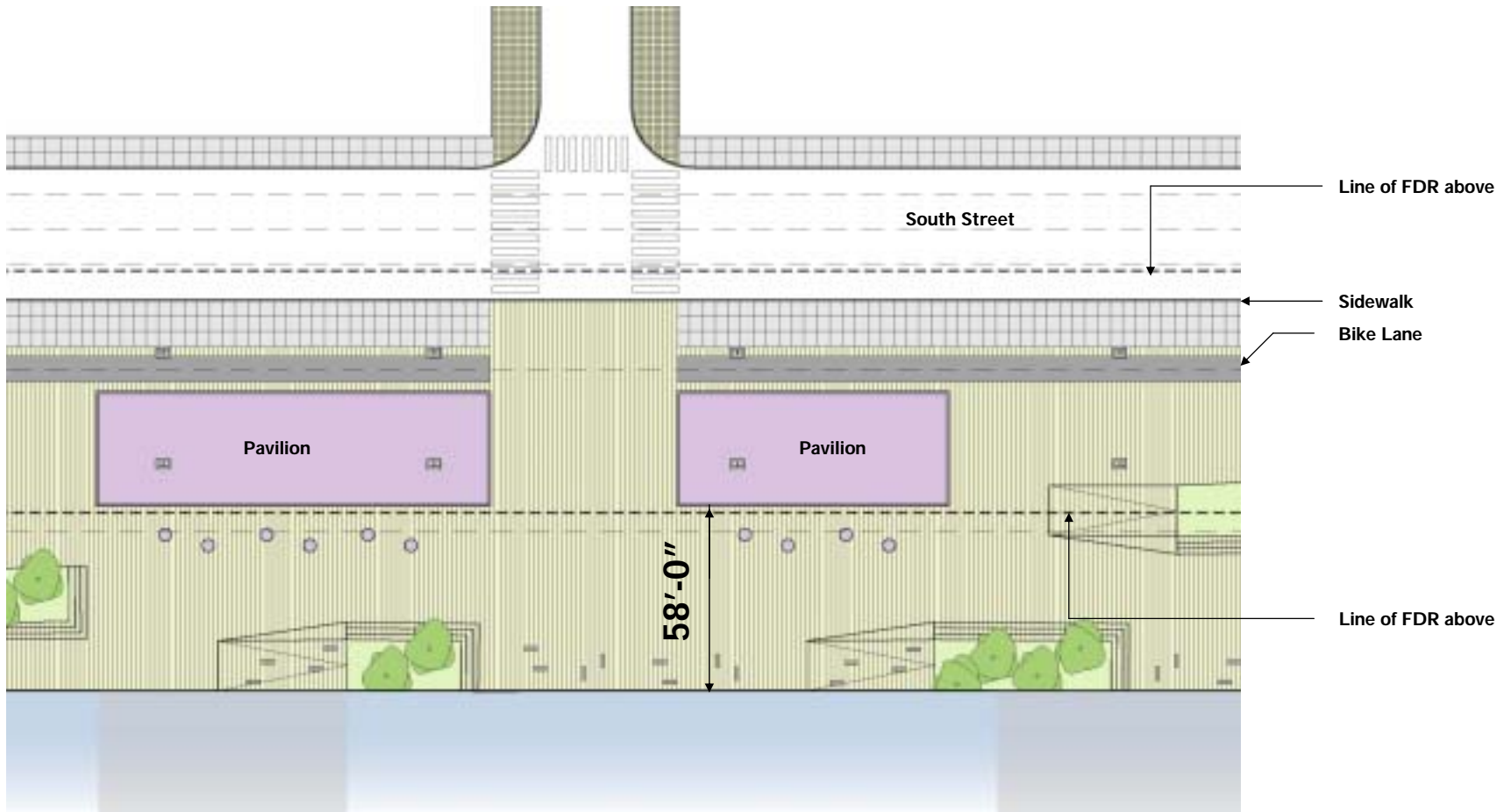



# New Esplanade



Pavilions

Bike Path

Plantings

Improved Boardwalk

Benches

Railing



## New Esplanade Pavilions under the FDR

- Create pavilions for culture, recreation and retail under the FDR
- Program responds to community needs





## New Esplanade Cladding the FDR

- Clad underside of FDR to improve lighting, sound, and appearance



# New Esplanade – Waterfront View





## New BMB Plaza

- Extend tunnel
- Create at-grade plaza in front of the Battery Maritime Building



- Provide green link to connect the Battery to the East River
- Entrance to Governors Island
- Create a more pedestrian friendly environment

# New BMB Plaza



# New BMB Plaza

Existing tunnel location



# New BMB Plaza



# New BMB Plaza





## Burling Slip

- Provide New Children's Playground
- Create connection with South Street Seaport Museum
- Provide opportunities for water-based amenities



# Burling Slip





## Pier 15



- Rebuild pier and provide community open space
- Provide docking for visiting ships and historic vessels

# Pier Structures



Current Pier Structure



Better Pier Structure  
needs longer span

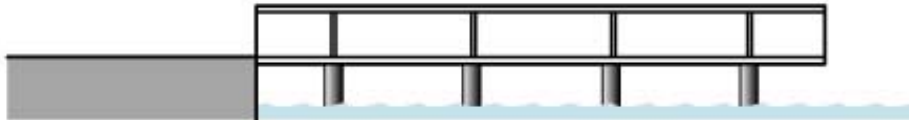

Verendeel Truss



Variated and Occupied  
Verendeel Truss

# Pier 15

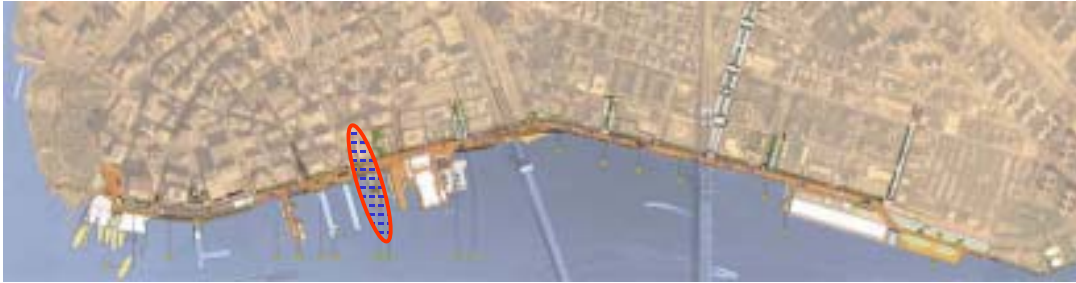

**New Esplanade**

**New Trellis with  
Porch swing**

**New Pier Park &  
Docking for Historic  
Wavertree**

**New waterfront  
overlook**

**New maritime  
program area**

**New seating areas**



# Pier 15





## Pier 17 & New Market Building



- Remove existing New Market Building and replace with a mixed use maritime center
- New transient boat dock

## Pier 17 - The New Market Building



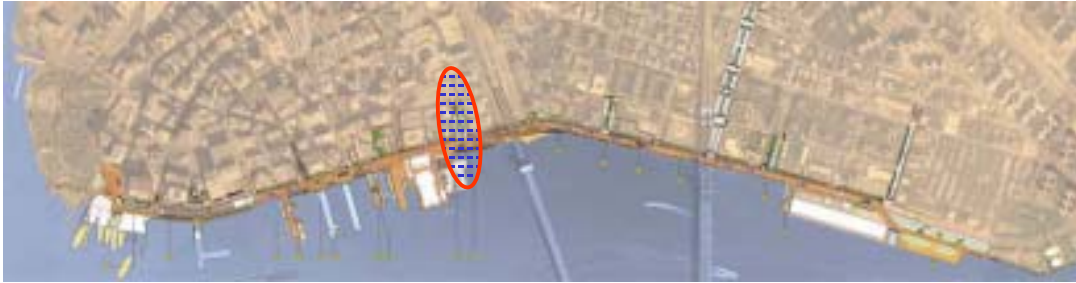

## Peck Slip



- Enhance the streetscape and provide new amenities
- Reconnect the neighborhood with the river
- Extend waterfront materials into the slips
- Replace parking with a public amenity

# Peck Slip Seasonal Use



# Peck Slip Seasonal Use



# Peck Slip



# Redefining the Slips



Catherine

Rutgers

Montgomery

- Enhance the streetscape and provide new amenities
- Reconnect the neighborhood with the river
- Extend waterfront materials into the slips



# Redefining the Slips

Catherine Slip





## Pike / Allen Street

- Enhance median
- Provide open space with improved lighting and benches
- Reinforce community initiatives
- Create continuous corridor to the waterfront



# Pike / Allen Street





## Pier 35



- Provide access to Pier 35
- Screen sanitation building with new trees and landscaping
- Provide opportunities for water dependent uses

# Pier 35

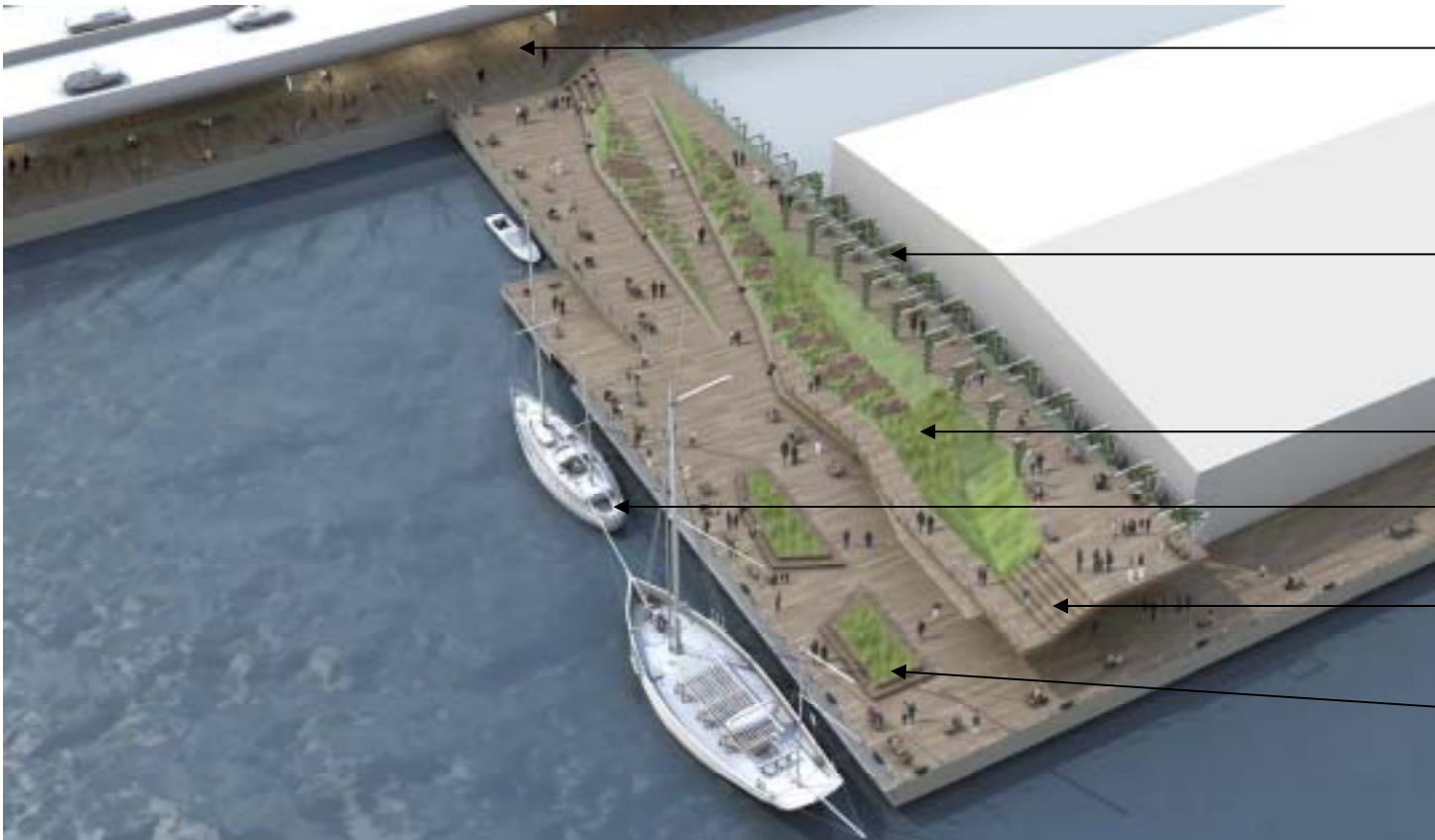

New Esplanade

Planting Screen  
for Existing  
Building

New Pier Park &  
Docking for Transient  
Boats

New viewing "porch"

New planting surfaces

# Pier 35





## East River Park Berm – Pier 42



- Expand and enhance access to East River Park
- Complete Manhattan greenway with link from esplanade to East River Park
- Provide landscape, acoustic, and visual buffer to the FDR



# East River Park Berm - Pier 42



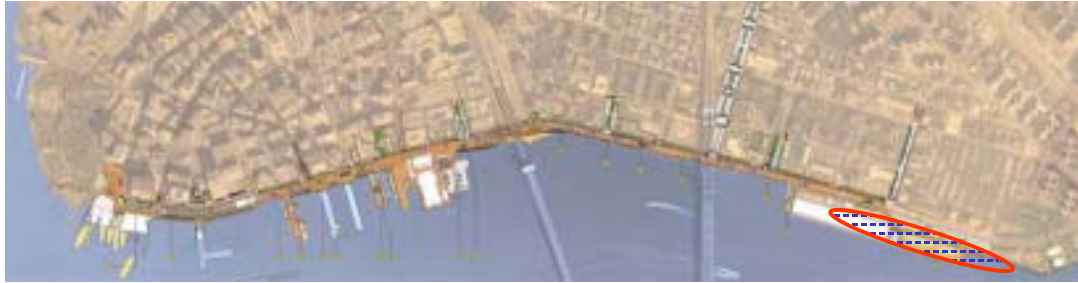

# East River Park Berm - Pier 42



# East River Park Berm – Pier 42



# The East River Waterfront

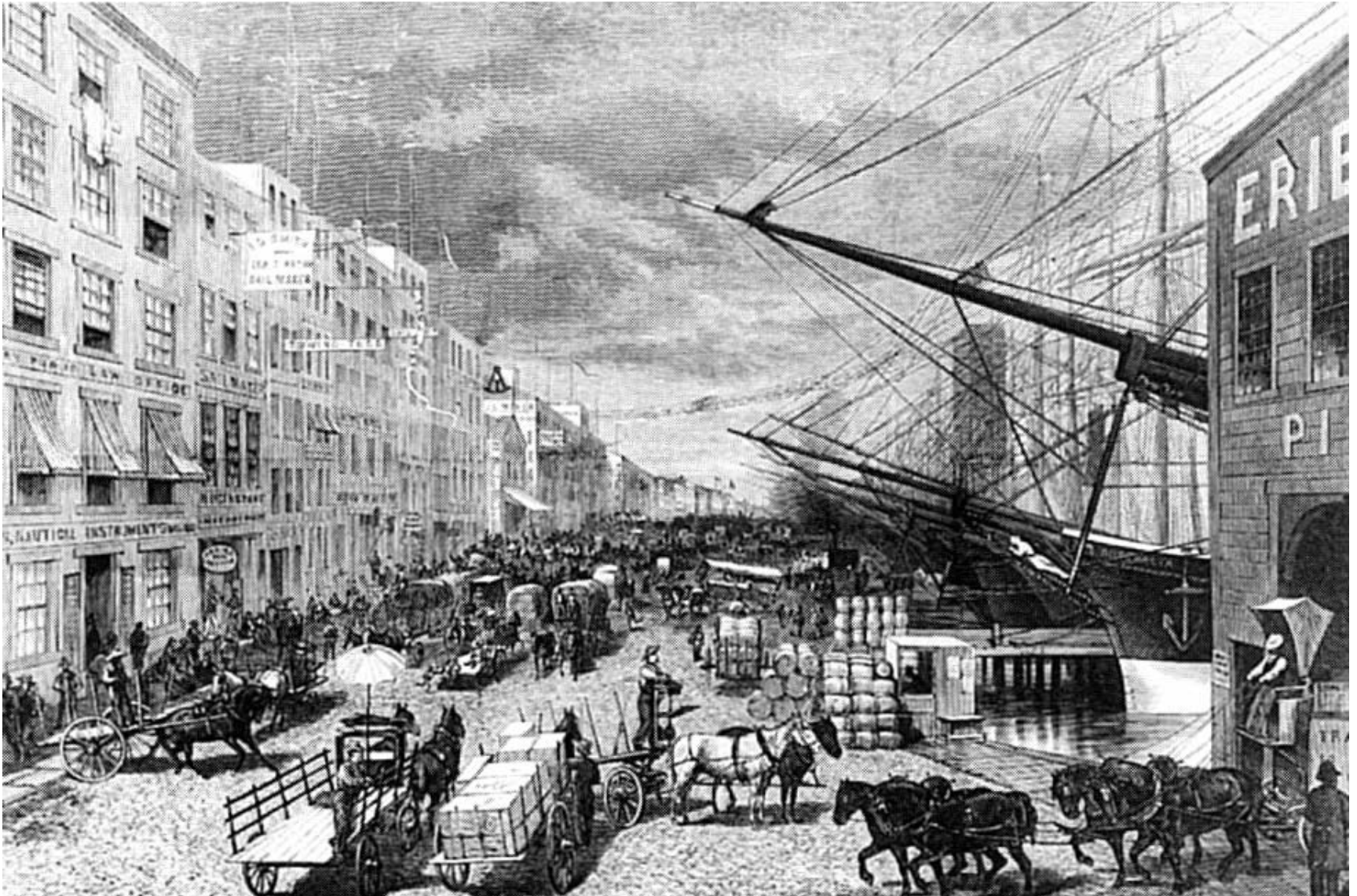

# The East River Waterfront - New Waterfront Destination

